

**Note:**

**A. - Soil, Waste, Vent & Rain Water pipe.**

1. All Internal & external soil,waste pipes (in shaft & Ceiling) are SWR pipe (IS: 13592- Type- B) with rubber ring / Solvent welded joints.
2. All Vent pipe (in shaft) are uPVC (IS- 4985) 4kg/cm<sup>2</sup> with fittings.
3. All external Soil & Waste line are uPVC pipe - (IS=4985)6kg/cm<sup>2</sup> with fittings.
4. All Terrace rain water lines in Shaft & Ceiling are SWR pipe (IS-13592 - type A)

**B. - Water Supply.**

1. All internal Hot & Cold water supply lines are SDR-11 grade CPVC pipes & fittings.
2. All External cold water supply lines(in shaft & terrace) are ASTM Sch-40 with ASTM fittings.

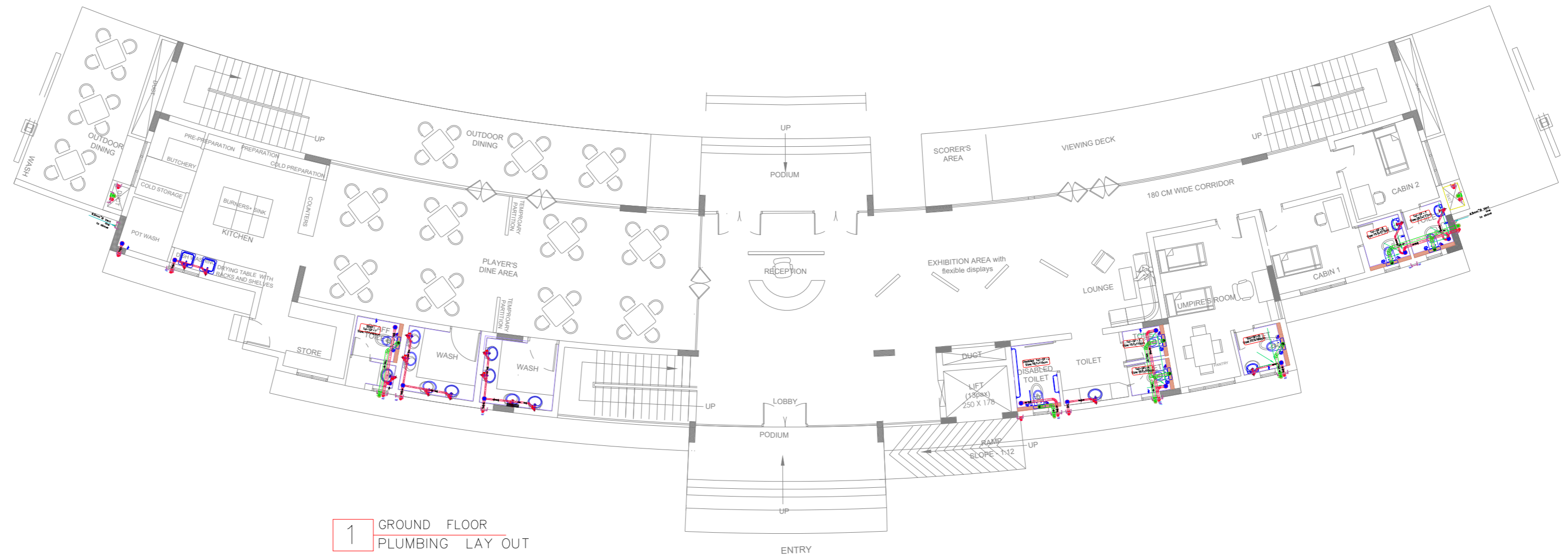

1 GROUND FLOOR PLUMBING LAY OUT

**LEGENDS**

1.		Wall Hung WC with Concealed flush valve
2.		Wash Basin counter top
3.		Wash Basin flat back with half pedestal
4.		Urinal
5.		Shower with wall mixer
6.		Floor Trap with anti cockroach gratings
7.		SS square frame with screw and rubber seal
8.		Long body tap
9.		Health faucet
10.		Brass Ball valve
11.		Angle valve
12.		Kitchen Sink
13.		Sewage line
14.		Waste water line
15.		Waste water line
16.		Hot Water Supply line Cpv
17.		Domestic Water Supply Cpv
18.		Waste water line
19.		Sewage line
20.		Anti Syphonic pipe
21.		Rodding Eye
22.		Terrace Rain water
23.		Domestic water supply
24.		Hot water supply
25.		Pipe drop down

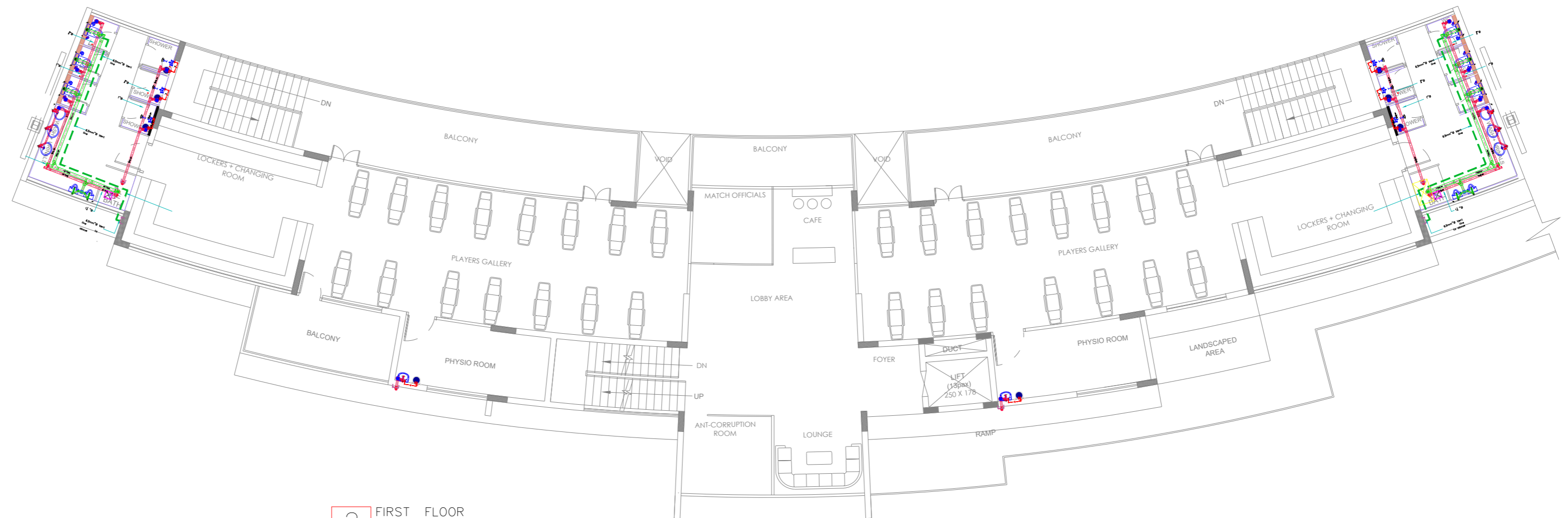

2 FIRST FLOOR PLUMBING LAY OUT

THIS DRAWING IS THE PROPERTY OF TECLA CONSULTANCY SOLUTIONS AND IS TO BE USED ONLY FOR THE PURPOSE FOR WHICH IT WAS LENT AND MUST NOT BE USED IN ANY WAY DETRIMENTAL TO THE INTEREST OF THE COMPANY AND IS SUBJECT TO RETURN ON DEMAND

ARCHITECT / CLIENT



**SHIBU ABOOSALI**  
ARCHITECTS

First Floor, No.7, Kamala Building,  
C-street, Jawahar Nagar, Kowdiar P O,  
Thiruvananthapuram, India 695003

REFERENCE DRAWING				REVISIONS				DRAWING STATUS		PAPER SIZE	A2	TECLA CONSULTANCY SOLUTIONS LF2, B5, 118, Vrindavan Garden, Pattom P.O, Thiruvananthapuram, Kerala, India - 695 004 projects@tecla.co.in   www.tecla.co.in
DRAWING NO.	DATE	REV.	NO	DATE	DRAWN	CHKD	APRVD.	CONCEPTUAL DRAWING	SCALE	1:15	DATE	
								FOR COMMENTS/ APPROVAL	APPROVED	AS	PROJECT NAME	PAVALION BLOCK FOR KCA STADIUM AT MANAGALPURAM
								FOR TENDER PUPOSE	CHECKED	AKS	PROJECT NO.	PJ/043/2021-22
								SANCTION DRAWING	DRAWN	NRC	DRAWING TITLE	PUBLIC HEALTH ENGINEERING SYSTEM DRAINAGE LAYOUT - GROUND & FIRST FLOOR
								GOOD FOR CONSTRUCTION	CHECKED	AKS	SHEET 01 OF 01	DWG. NO.: TCS_043_01_PHE_DL_P00
								FOR INFORMATION	DESIGNED	AS		
								AS BUILT				



**Note:**

**A. - Soil, Waste, Vent & Rain Water pipe.**

1. All Internal & external soil, waste pipes (in shaft & Ceiling) are SWR pipe (IS: 13592- Type- B) with rubber ring / Solvent welded joints.
2. All Vent pipe (in shaft) are uPVC (IS- 4985) 4kg/cm<sup>2</sup> with fittings.
3. All external Soil & Waste line are uPVC pipe - (IS=4985)6kg/cm<sup>2</sup> with fittings.
4. All Terrace rain water lines in Shaft & Ceiling are SWR pipe (IS-13592 - type A)

**B. - Water Supply.**

1. All internal Hot & Cold water supply lines are SDR-11 grade CPVC pipes & fittings.
2. All External cold water supply lines (in shaft & terrace) are ASTM Sch-40 with ASTM fittings.

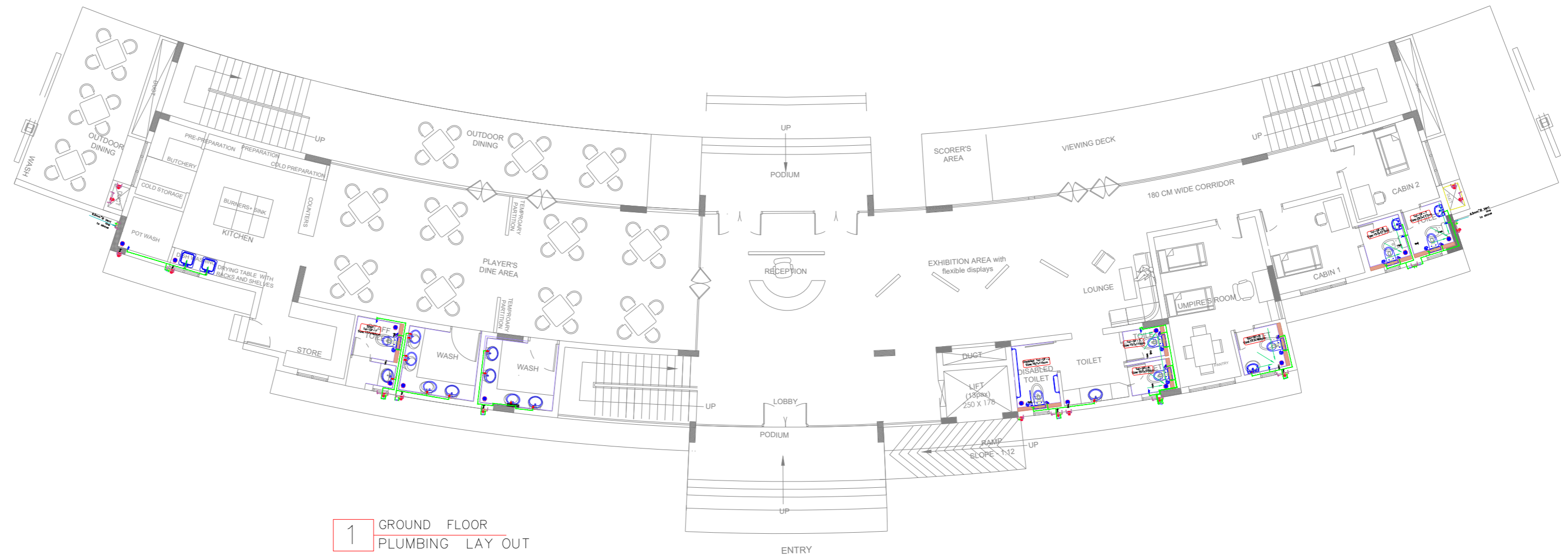

**LEGENDS**

1.		Wall Hung WC with Concealed flush valve
2.		Wash Basin counter top
3.		Wash Basin flat back with half pedestal
4.		Urinal
5.		Shower with wall mixer
6.		Floor Trap with anti cockroach gratings
7.		SS square frame with screw and rubber seal
8.		Long body tap
9.		Health faucet
10.		Brass Ball valve
11.		Angle valve
12.		Kitchen Sink
13.		Sewage line
14.		Waste water line
15.		Waste water line
16.		Hot Water Supply line Cpv
17.		Domestic Water Supply Cpv
18.		Waste water line
19.		Sewage line
20.		Anti Syphonic pipe
21.		Rodding Eye
22.		Terrace Rain water
23.		Domestic water supply
24.		Hot water supply
25.		Pipe drop down

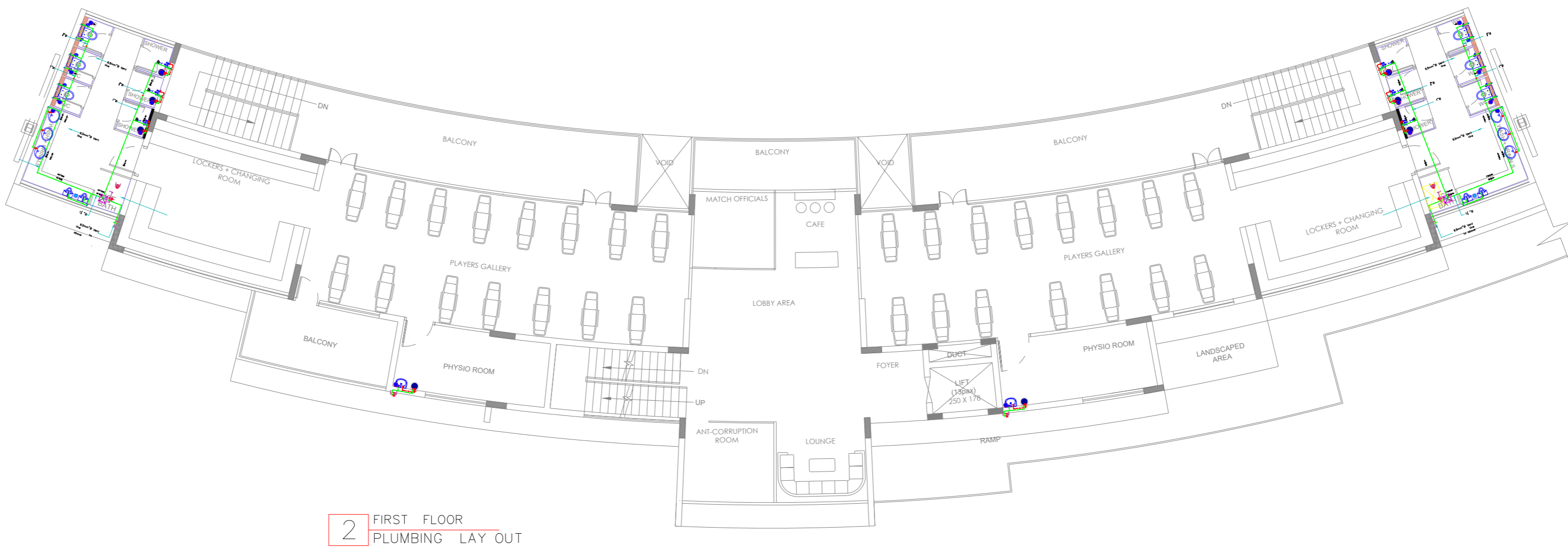

THIS DRAWING IS THE PROPERTY OF TECLA CONSULTANCY SOLUTIONS AND IS TO BE USED ONLY FOR THE PURPOSE FOR WHICH IT WAS LENT AND MUST NOT BE USED IN ANY WAY DETRIMENTAL TO THE INTEREST OF THE COMPANY AND IS SUBJECT TO RETURN ON DEMAND

ARCHITECT / CLIENT

**SHIBU ABOOSALI**  
ARCHITECTS

First Floor, No.7, Kamala Building,  
C-street, Jawahar Nagar, Kowdiar P O,  
Thiruvananthapuram, India 695003

REFERENCE DRAWING					REVISIONS					DRAWING STATUS			PAPER SIZE	SCALE	DATE	APPROVED	CHECKED	DRAWN	CHECKED	DESIGNED	PROJECT NO.	DRAWING TITLE	REV.
										CONCEPTUAL DRAWING			A2	1:15	16-05-2022	AS	AKS	NRC	AKS	AS	PJ/043/2021-22	PUBLIC HEALTH ENGINEERING SYSTEM WATER SUPPLY LAYOUT - GROUND & FIRST FLOOR	
										FOR COMMENTS/ APPROVAL													
										FOR TENDER PUPOSE													
										SANCTION DRAWING													
										GOOD FOR CONSTRUCTION													
										FOR INFORMATION													
										AS BUILT													

**TECLA** CONSULTANCY SOLUTIONS  
ASMEP SOLUTIONS

LF2, B5, 118, Vrindavan Garden, Pattom P.O,  
Thiruvananthapuram, Kerala, India - 695 004  
projects@tecla.co.in | www.tecla.co.in

PROJECT NAME: PAVALION BLOCK FOR KCA STADIUM AT MANAGALPURAM

DWG. NO.: TCS\_043\_01\_PHE\_WS\_P00



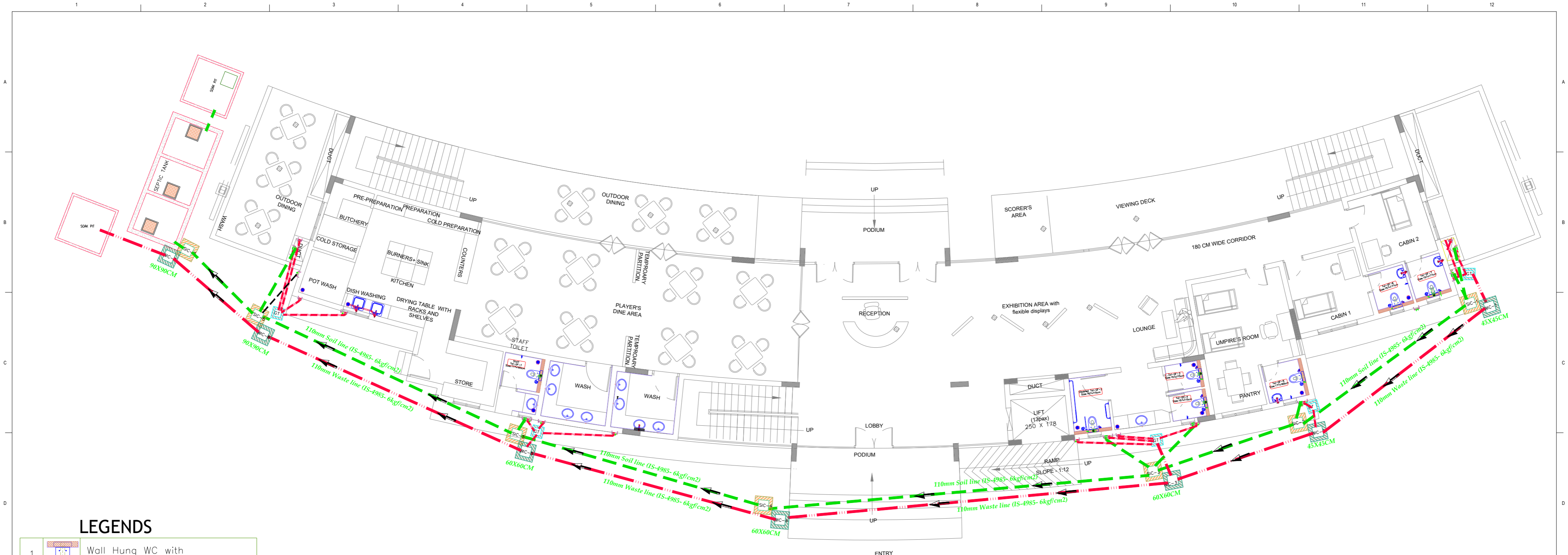

**LEGENDS**

- 1. Wall Hung WC with Concealed flush valve
- 2. Wash Basin counter top
- 3. Wash Basin flat back with half pedestal
- 4. Urinal
- 5. Shower with wall mixer
- 6. Floor Trap with anti cockroach gratings
- 7. SS square frame with screw and rubber seal
- 8. Long body tap
- 9. Health faucet
- 10. Brass Ball valve
- 11. Angle valve
- 12. Kitchen Sink
- 13. Sewage line
- 14. Waste water line
- 15. Waste water line
- 16. Hot Water Supply line Cpv
- 17. Domestic Water Supply Cpv
- 18. Waste water line
- 19. Sewage line
- 20. Anti Syphonic pipe
- 21. Rodding Eye
- 22. Terrace Rain water
- 23. Domestic water supply
- 24. Hot water supply
- 25. Pipe drop down

**4** GROUND FLOOR  
EXTERNAL DRAINAGE LAY OUT

**Note:**  
**A. - Soil, Waste, Vent & Rain Water pipe.**  
 1. All Internal & external soil,waste pipes (in shaft & Ceiling )are SWR pipe (IS: 13592-Type- B) with rubber ring / Solvent welded joints.  
 2. All Vent pipe (in shaft) are uPVC (IS- 4985) 4kg/cm<sup>2</sup> with fittings.  
 3. All external Soil & Waste line are uPVC pipe - (IS=4985)6kg/cm<sup>2</sup> with fittings.  
 4. All Terrace rain water lines in Shaft & Ceiling are SWR pipe (IS-13592 - type A)  
**B. - Water Supply.**  
 1. All internal Hot & Cold water supply lines are SDR-11 grade CPVC pipes & fittings.  
 2. All External cold water supply lines(in shaft & terrace) are ASTM Sch-40 with ASTM fittings.

**MANHOLE SCHEDULE**

SOIL INSPECTION CHAMBER				
INSPECTION CHAMBER NO:	MANHOLE SIZE (CM)	COVER LEVEL (CM)	INVERT LEVEL (CM)	DEPTH (CM)
SIC-01	45x45	± Ivl	-45.00	45.00
SIC-02	45x45	± Ivl	-54.00	54.00
SIC-03	60x60	± Ivl	-61.00	61.00
SIC-04	60x60	± Ivl	-78.00	78.00
SIC-05	60x60	± Ivl	-89.00	89.00
SIC-06	90x90	± Ivl	-102.00	102.00
SIC-07	90x90	± Ivl	-106.00	106.00
SIC-08	90x90	± Ivl	-115.00	115.00

**MANHOLE SCHEDULE**

SOIL INSPECTION CHAMBER				
INSPECTION CHAMBER NO:	MANHOLE SIZE (CM)	COVER LEVEL (CM)	INVERT LEVEL (CM)	DEPTH (CM)
WIC-01	45x45	± Ivl	-45.00	45.00
WIC-02	45x45	± Ivl	-54.00	54.00
WIC-03	45x45	± Ivl	-61.00	61.00
WIC-04	45x45	± Ivl	-78.00	78.00
WIC-05	60x60	± Ivl	-89.00	89.00
WIC-06	60x60	± Ivl	-102.00	102.00
WIC-07	60x60	± Ivl	-106.00	106.00
WIC-08	90x90	± Ivl	-115.00	115.00

THIS DRAWING IS THE PROPERTY OF TECLA CONSULTANCY SOLUTIONS AND IS TO BE USED ONLY FOR THE PURPOSE FOR WHICH IT WAS LENT AND MUST NOT BE USED IN ANY WAY DETRIMENTAL TO THE INTEREST OF THE COMPANY AND IS SUBJECT TO RETURN ON DEMAND

ARCHITECT / CLIENT  
**SHIBU ABOOSALI**  
 ARCHITECTS  
 First Floor, No.7, Kamala Building,  
 C-street, Jawahar Nagar, Kowdiar P O,  
 Thiruvananthapuram, India 695003

DRAWING NO.	DATE	REV.	NO	DATE
REFERENCE DRAWING				
REVISIONS				

DRAWING STATUS		PAPER SIZE	A2
CONCEPTUAL DRAWING		SCALE	1:12.5
FOR COMMENTS/ APPROVAL	<input checked="" type="checkbox"/>	DATE	16-05-2022
FOR TENDER PUPOSE	<input checked="" type="checkbox"/>	APPROVED	AS
SANCTION DRAWING	<input checked="" type="checkbox"/>	CHECKED	AKS
GOOD FOR CONSTRUCTION	<input checked="" type="checkbox"/>	DRAWN	NRC
FOR INFORMATION	<input checked="" type="checkbox"/>	CHECKED	AKS
AS BUILT	<input checked="" type="checkbox"/>	DESIGNED	AS

TECLA CONSULTANCY SOLUTIONS  
 LF2, B5, 118, Vrindavan Garden, Pattom P.O,  
 Thiruvananthapuram, Kerala, India - 695 004  
 projects@tecla.co.in | www.tecla.co.in

PROJECT NAME: PAVALION BLOCK FOR KCA STADIUM AT MANAGALPURAM  
 PROJECT NO.: PU/043/2021-22  
 DRAWING TITLE: PUBLIC HEALTH ENGINEERING SYSTEM WATER SUPPLY LAYOUT - GROUND & FIRST FLOOR  
 SHEET 01 OF 01 DWG. NO.: TCS\_043\_01\_PHE\_WS\_P00